

## 5.5 CREATIVITY WAY CONCEPT - DETAILED PLAN

Note: The design and materials of Creativity Way are still under review and subject to further refinement.



### KEY

- 1. Fay House
- 2. Ballard House
- 3. CW Gateway
- 4. 6th St Parcel 2A1

### Materials/Planting

- A. Mix of stone and brick pavers with tactile paving at transitions
- B. Stabilized decomposed granite
- C. Cast-in-place concrete edges with embedded planters
- D. Soft and impervious landscaping
- E. Trees (species to be confirmed)

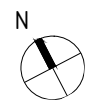

0' 3' 6' 9' 12'



6th St Development

Creativity Way

ZONING COMMISSION  
District of Columbia  
CASE NO.12-15C  
EXHIBIT NO.31D

## 5.6 CREATIVITY WAY CONCEPT - HARDSCAPE PRECEDENTS

The following images illustrate the style and character of the hard landscaping that we envision for the Creativity Way project.

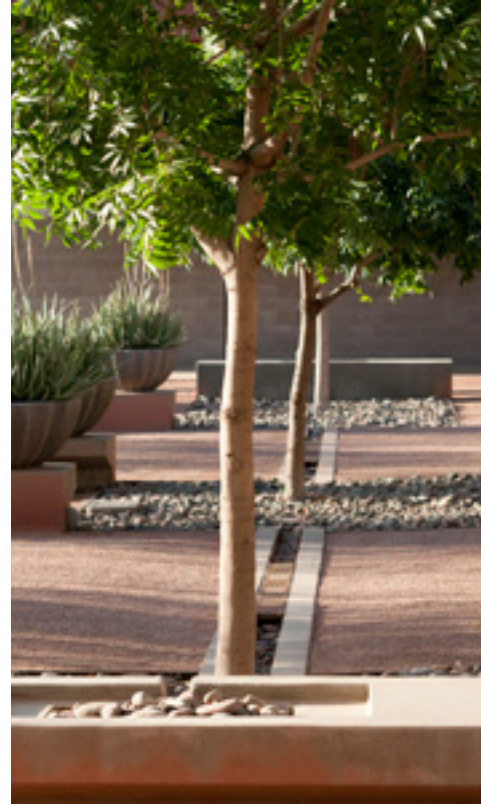

## 5.7 CREATIVITY WAY CONCEPT - PLANTING PRECEDENTS

The following images illustrate the style and character of the planting that we envision for the Creativity Way project.

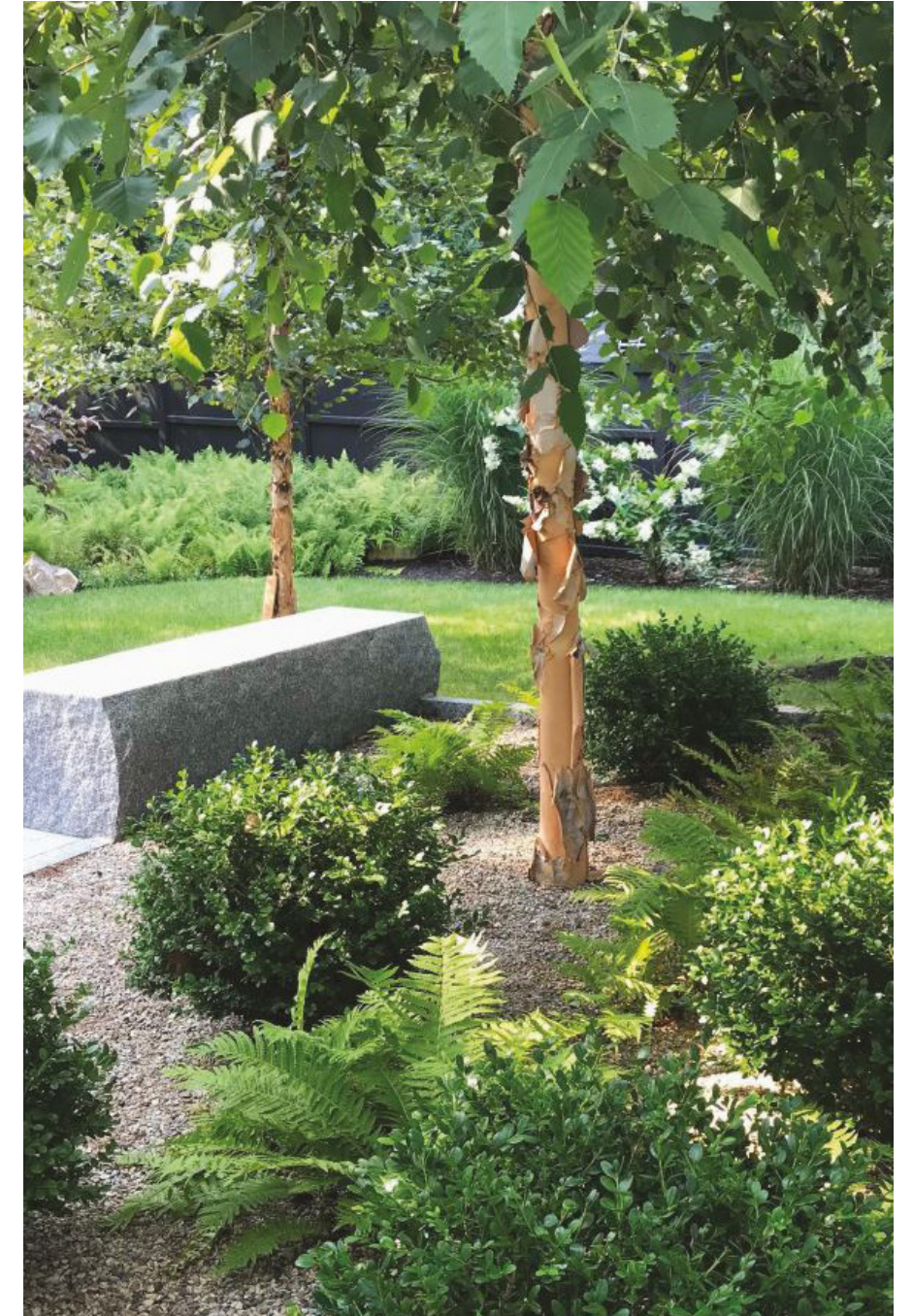

5.7 CREATIVITY WAY CONCEPT - PLANTING PRECEDENTS

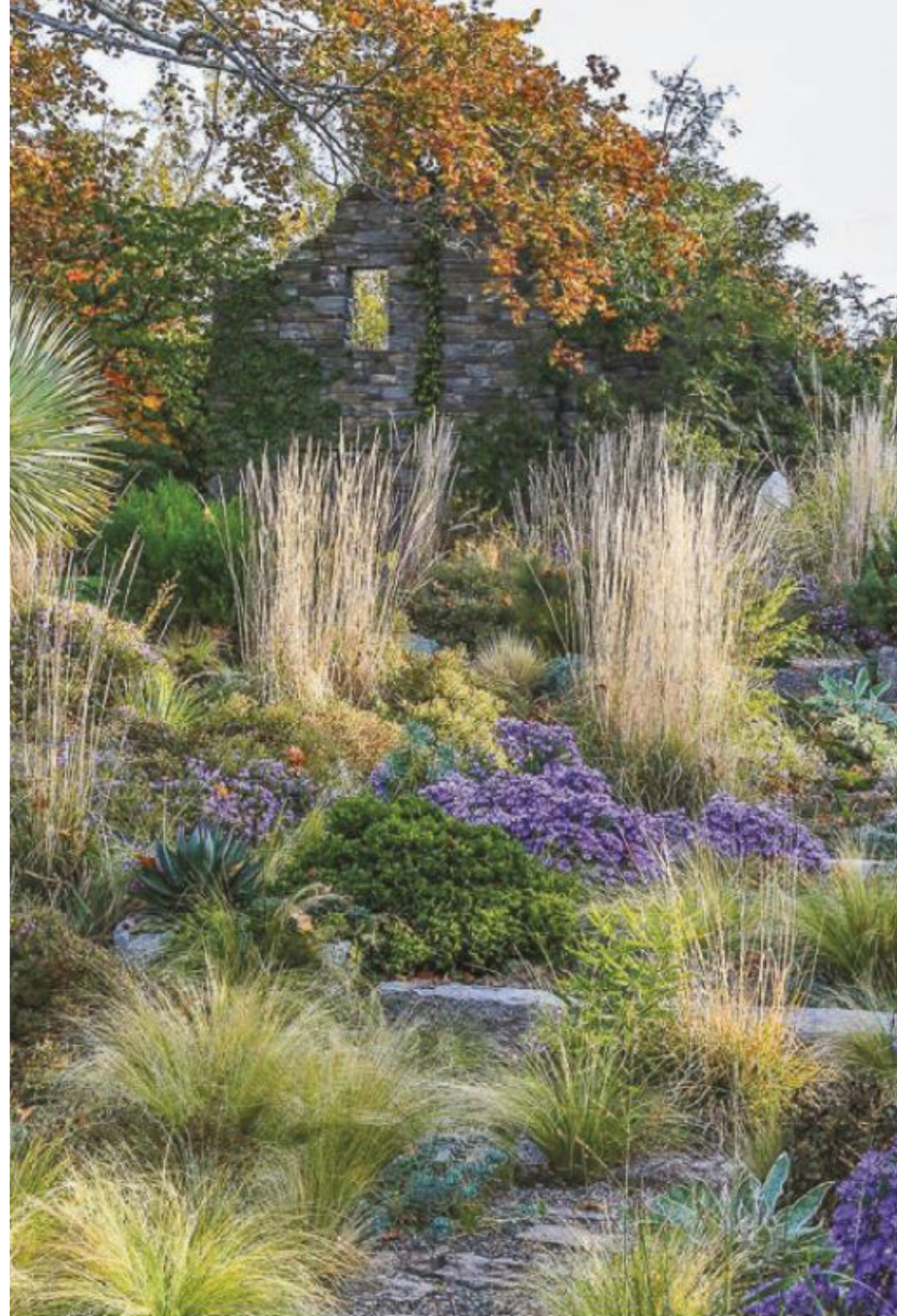

## 5.8 CREATIVITY WAY CONCEPT - WAYFINDING + ARTWORK PRECEDENTS

The following images demonstrate some examples of wayfinding that could be envisioned for the three entrance routes into the Campus.

The images also illustrate the potential to work with artists to help represent a number of diverse user-groups.

The image in the centre of the page illustrates how the entrance portals could be utilised to hang banners and other signages as well as serving the purpose of way-finding for the general public.



View illustrating event signage attached to Creativity Way structure, visible from 6th Street.

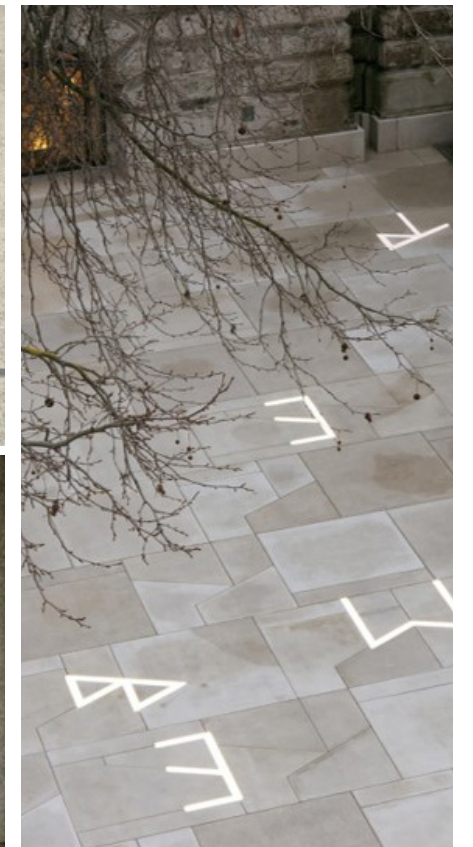

## 5.8 CREATIVITY WAY CONCEPT - WAYFINDING + ARTWORK PRECEDENTS

A series of visuals illustrating the how the northern portal - the one that addresses Tapscott St - is designed to optimise and foster connectivity between Creativity Way and 6th Street and how it can be utilised to support the project's wayfinding strategies.



1. View illustrating how the Creativity Way structures will offer opportunities for shelter and seating



2. View illustrating event signage attached to Creativity Way structure which will be visible from 6th Street.



3. Night-time view illustrating well-lit focal points to draw and welcome visitors to Creativity Way from 6th Street.

## 5.8 CREATIVITY WAY CONCEPT - WAYFINDING + ARTWORK PRECEDENTS

A series of visuals illustrating how it is envisaged that Creativity Way's design development will proceed in such a way as to include public art and features that can be enjoyed and explored by children whilst providing shelter and seating for parents/guardians



An example of how the vertical wall surface could be utilised as a chalk-board wall for children to engage with. There will also be opportunities for step-stool play areas in the soft landscaping areas - as shown to the right of this image.

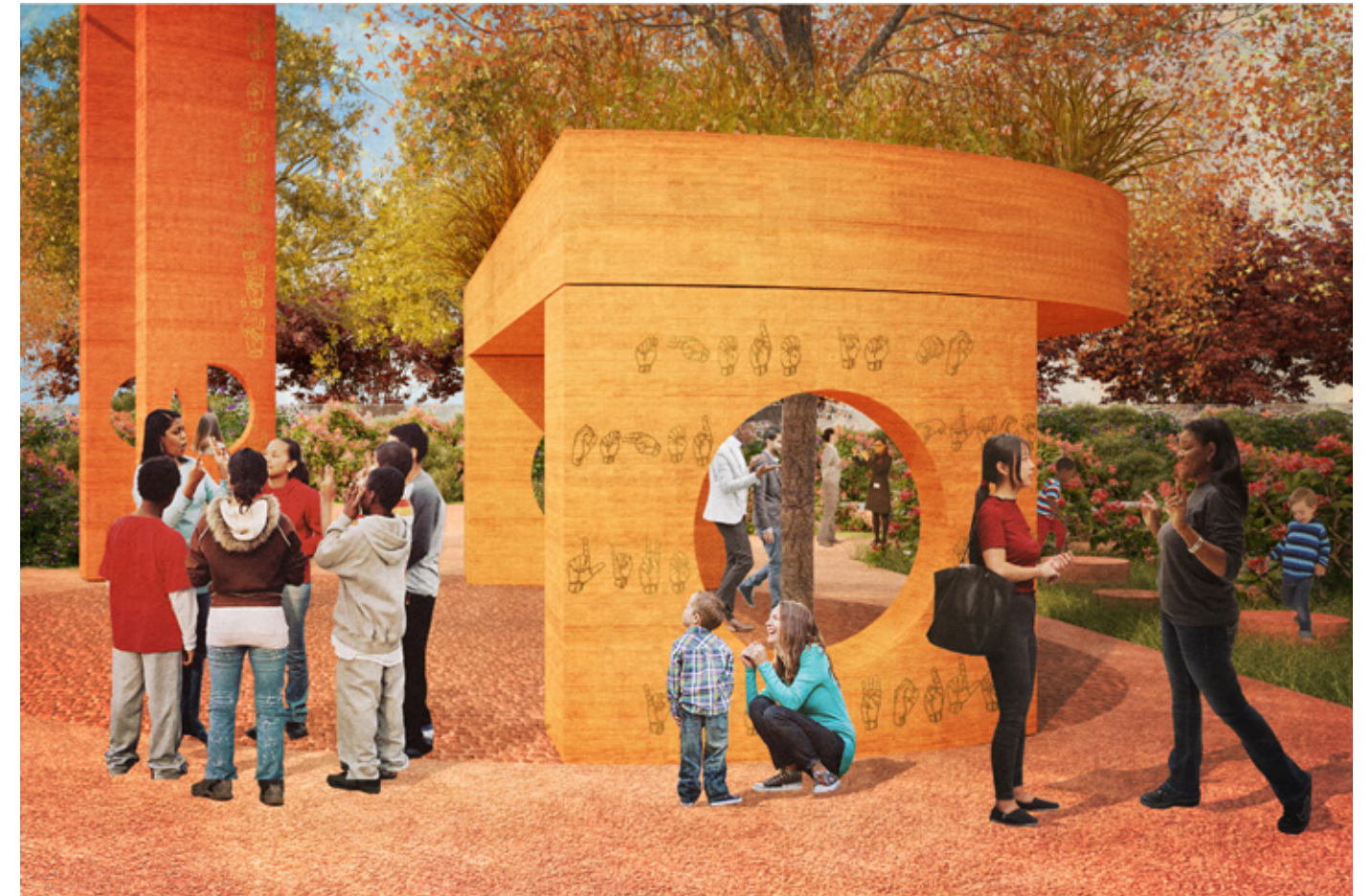

An example of how ASL signs could be etched onto the vertical wall surfaces to help raise awareness among the public.

## 5.8 CREATIVITY WAY CONCEPT - WAYFINDING + ARTWORK PRECEDENTS

A series of visuals illustrating how it is envisaged that Creativity Way's design development will proceed in such a way as to include public art and features that can be enjoyed and explored by children whilst providing shelter and seating for parents/guardians



An example of how permanent relief work on the walls could be used to characterise the architecture of the historic campus.



An example of how Creativity Way could be a home to some permanent public sculptures or support a temporary sculpture exhibition.